

**THERMALRIGHT®**

**Macho 120 Rev. B CPU Cooler Installation Guide**

**PARTS LIST**

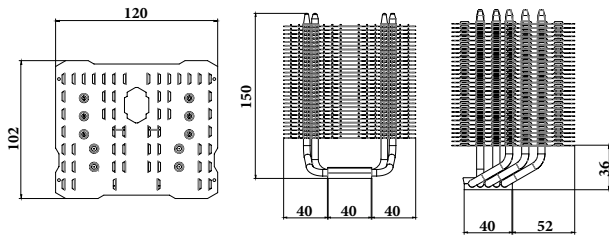

Please follow the Installation Guide before installing this product.  
 Please do NOT modify or disassemble this product.  
 Please keep this product AWAY from children.  
 Please do NOT use this product for the non-PC environment.  
 Please do NOT apply too much thermal paste will lower heat conductivity and cooling performance!  
 To prevent electrical shocks, please turn off system power and unplug the power of the system before beginning the installation.

|                                     |  |                                    |                               |                                       |                                 |
|-------------------------------------|--|------------------------------------|-------------------------------|---------------------------------------|---------------------------------|
| <b>A</b><br><br>Metal Back Plate x1 | <b>B</b><br><br>Mylar x1                   | <b>C</b><br><br>775 Back Cap x1    | <b>D</b><br><br>AMD Washer x4 | <b>E</b><br><br>Intel Washer x4       | <b>F</b><br><br>M3L10 Screws x5 |
| <b>G</b><br><br>Screw Nut x4        | <b>H</b><br><br>M3L6 Screws x7             | <b>I</b><br><br>Anchoring Mount x1 | <b>J</b><br><br>TF4 x1        | <b>K</b><br><br>LGA2011 Screw Nuts x4 | <b>L</b><br><br>Fan Clips x4    |
| <b>M</b><br><br>Macho 120 Rev. B x1 | <b>N</b><br><br>(43x2.6) Mounting Plate x1 | <b>O</b><br><br>TY-121 Fan x1      |                               |                                       |                                 |

**AMD AM4 Platform**

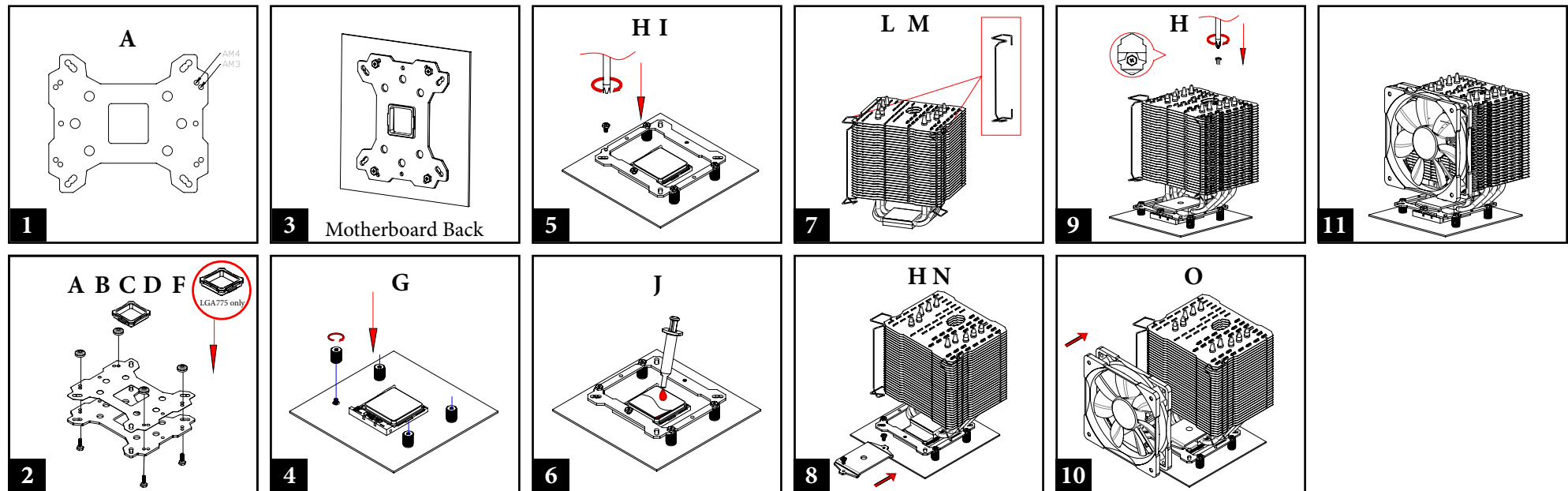

## Intel LGA 775/115x/1366 Platform

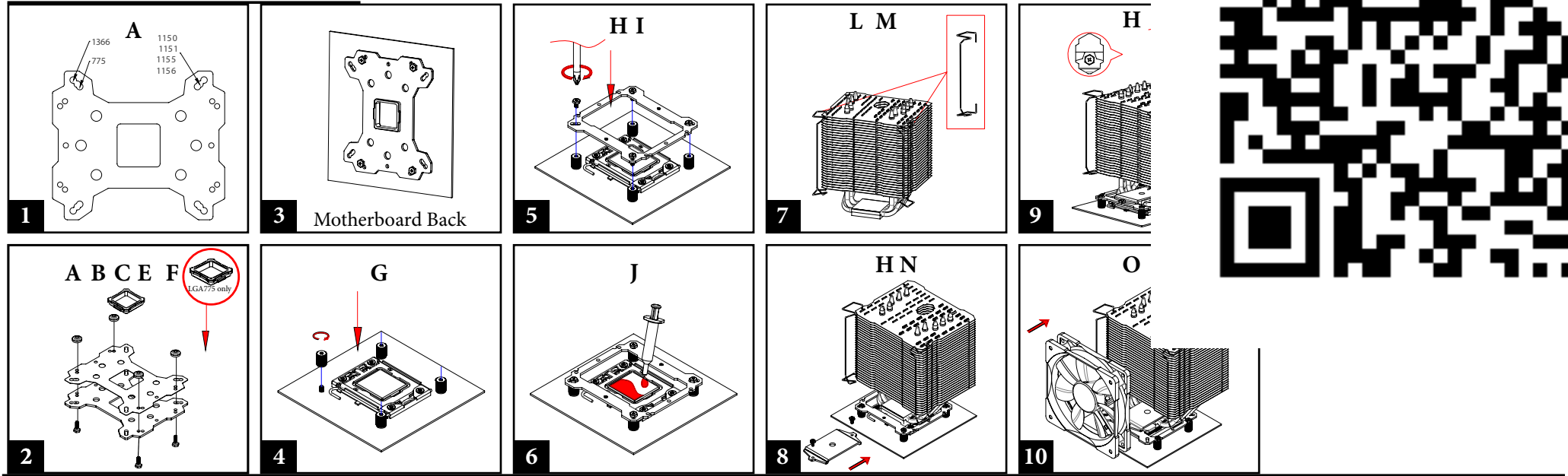

## Intel LGA 2011/2011-3/2066 Platform

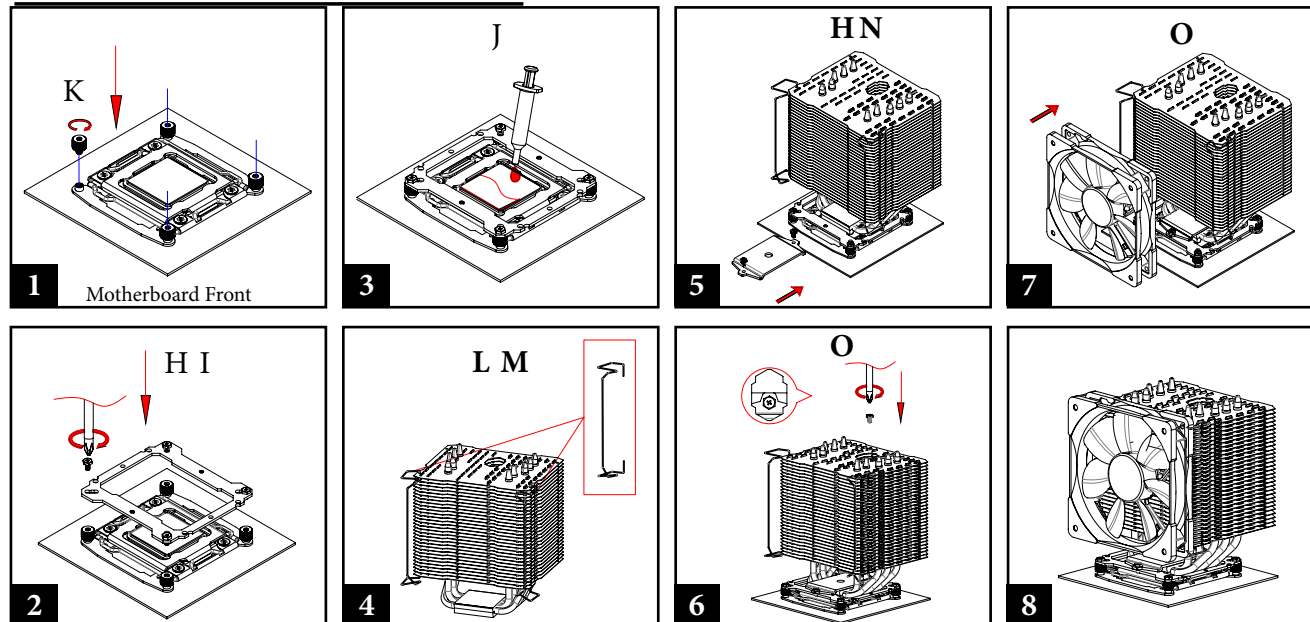

### LGA 1151 Spacer Installation

Skylake only

